

JOHNNY G SPIRIT BIKE

STRAVA® + KINOMAP® CONNECTION GUIDE

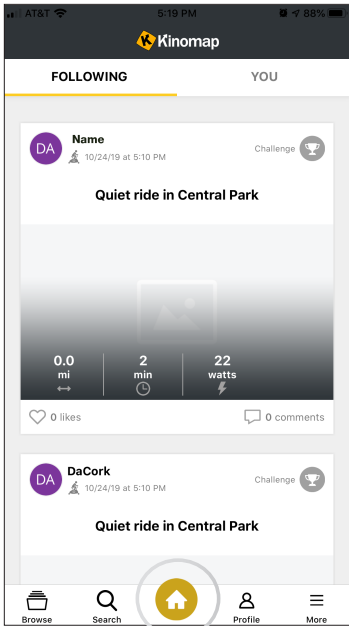

Following ride, select *HOME* key.

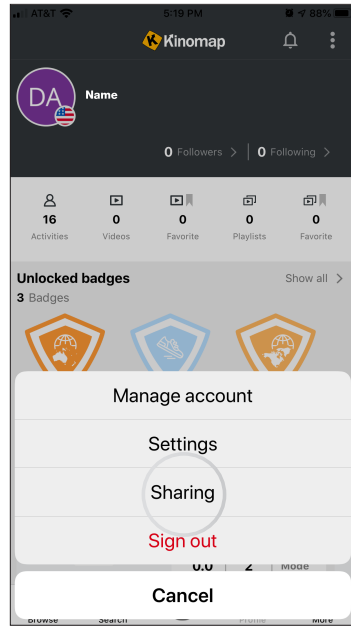

Select *SHARING*.

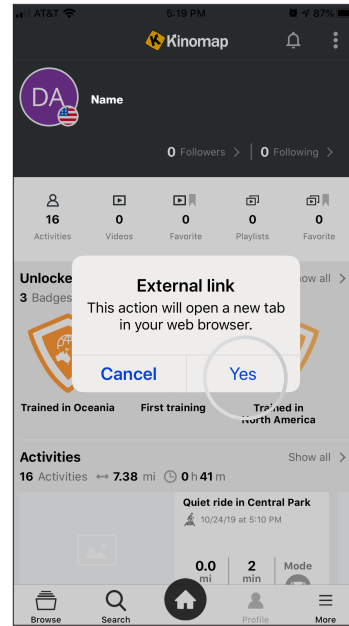

Select *YES* to follow external link.

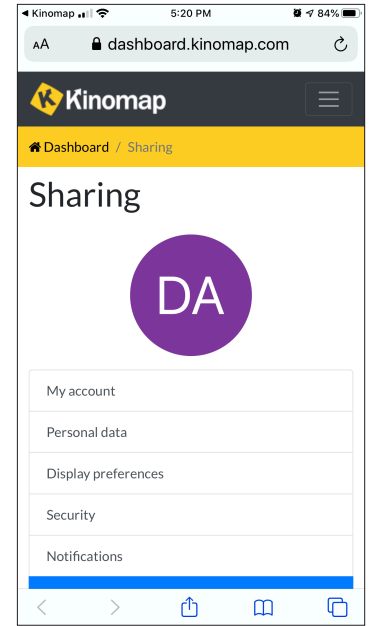

Scroll down until *STRAVA* displays and select *STRAVA*.

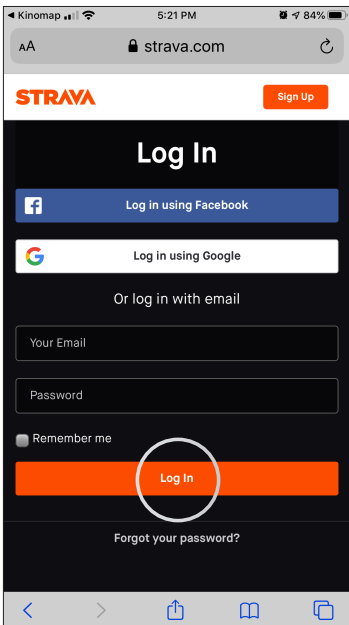

Log into your Strava account.

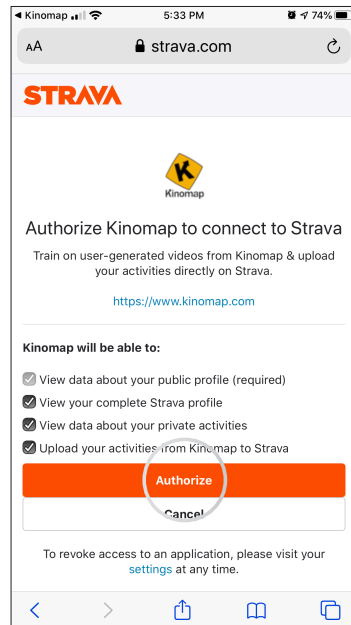

Authorize Kinomap to connect to Strava. Screen will display successful connection.

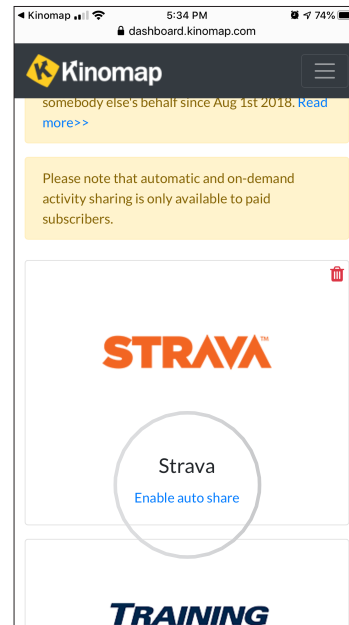

Scroll down and *ENABLE AUTO SHARE*.

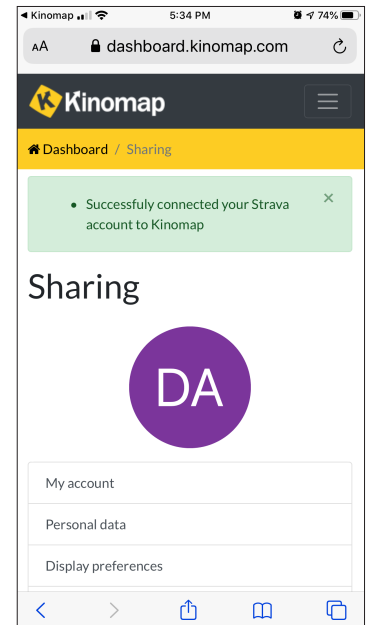

Screen displays auto upload to Strava.